

52 Commercial Street, Lerwick, Shetland ZE1 0BD.

T: 01595 692297 F: 01595 692247  
E: [solicitors@anderson-goodlad.co.uk](mailto:solicitors@anderson-goodlad.co.uk)

[www.anderson-goodlad.co.uk](http://www.anderson-goodlad.co.uk)

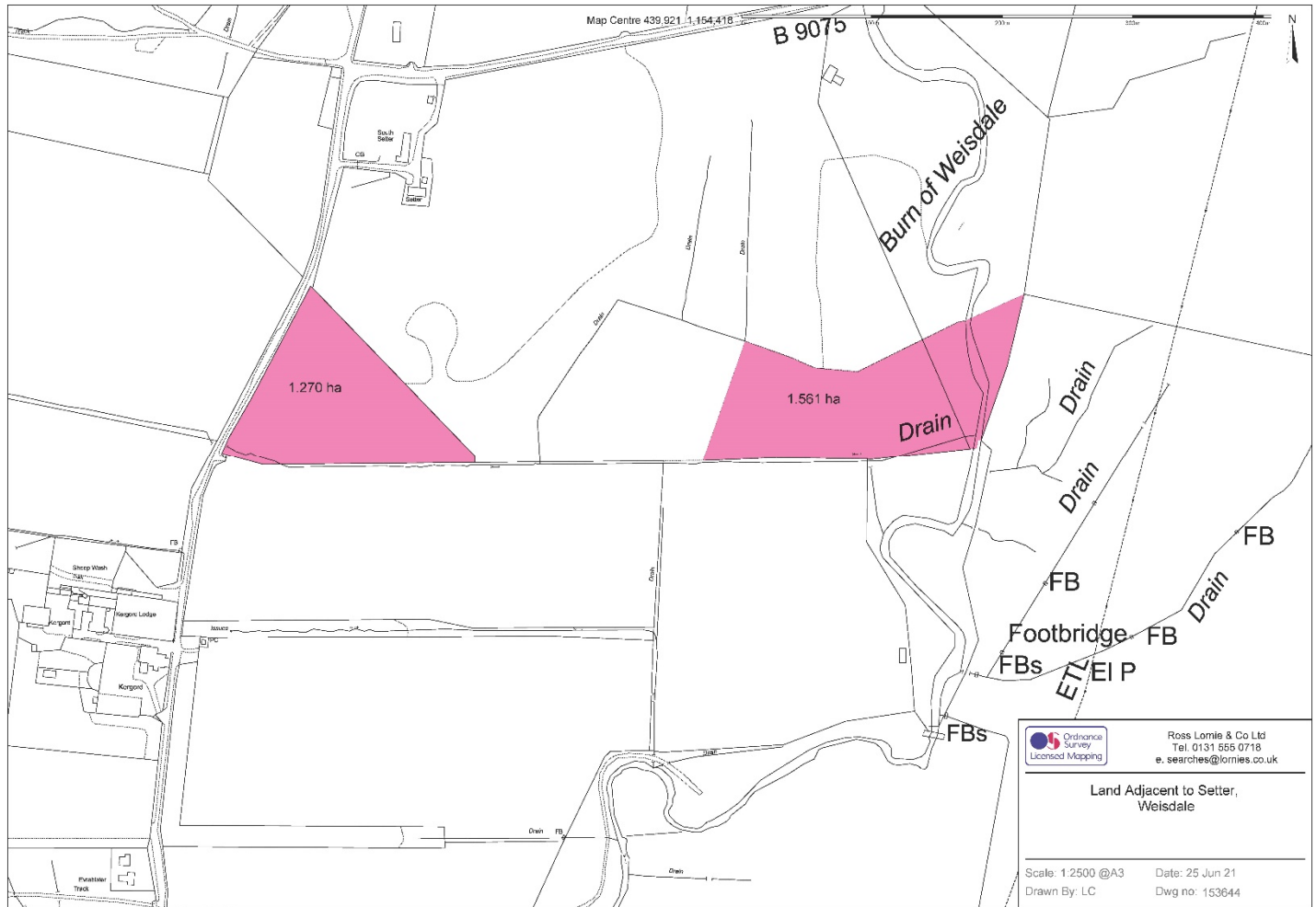

## Areas of ground at Setter, Weisdale, Shetland

A great opportunity to purchase these two discontinuous, non-croft areas of ground. The triangular area extends to 1.270 hectares (3.13 acres) with the other area extending to 1.561 hectares (3.85 acres). They are both registered in the Land Register of Scotland under Title Number OAZ17501 and are situated in the central belt of mainland Shetland, just north of Kergord Woods on the B9075.

There are no buildings situated on the areas of ground.

These areas provide an ideal opportunity for established crofters/farmers requiring additional grazing or those wishing to try their hand on a small holding.

If you wish to view the areas of ground, please do so at your convenience.

Offers or written enquiries are invited and should be submitted to Anderson & Goodlad.

*Further particulars and Home Report from and all offers to:-*

**Anderson & Goodlad, Solicitors**

52 Commercial Street, Lerwick, Shetland, ZE1 0BD

T: 01595 692297 F: 01595 692247 E: [solicitors@anderson-goodlad.co.uk](mailto:solicitors@anderson-goodlad.co.uk) W: [www.anderson-goodlad.co.uk](http://www.anderson-goodlad.co.uk)